

# RESORT COLLECTION

## THE PRAYA | 2 BEDROOM POOL VILLA

THE  
GALERI  
BEACH RESORT & RESIDENCES  
LOMBOK



*Inspired by the richness of Indonesian culture combined with contemporary style and flair, every villa within The Galeri Beach Resort & Residences sets a new standard for luxury living.*

Designed to please and built to last, our luxurious Resort Collection villas are engineered to help you enjoy Lombokian living at its finest.

From its lofty cathedral ceilings and artisan stone and timber flooring to the shop fitted kitchens and luxury brand fixtures and appliances, every inch of your villa enjoys impeccable attention to detail. Fully furnished by our talented team of interior designers, our luxury Resort Collection villas also sport large screen TVs with DVD and satellite, integrated sound systems, architectural lighting as well as remote controlled air conditioning and fans.

Each of our fully managed and maintained villas also boasts a traditional Indonesian gateway that welcomes you to your lushly landscaped private garden and your very own swimming pool, offering nothing but the best in indoor comfort and outdoor style.





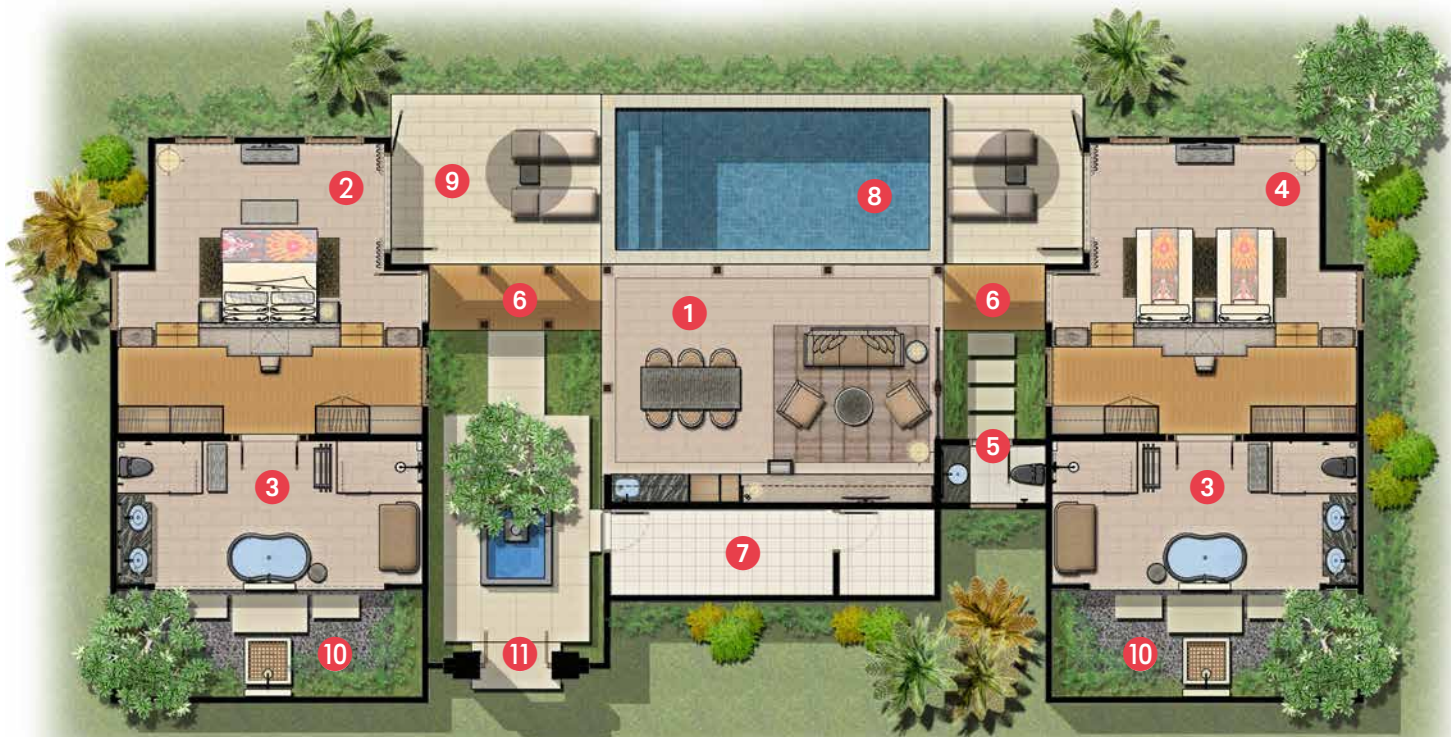

*Purchasers of whole ownership villas may opt for an alternate double master bedroom plan in lieu of one master and one twin bedroom configuration*

#### KEY

- ❶ LIVING PAVILION
- ❷ MASTER BEDROOM
- ❸ EN SUITE BATHROOM
- ❹ TWIN BEDROOM
- ❺ POWDER ROOM
- ❻ COVERED WALKWAY
- ❼ UTILITY & STORAGE
- ❽ SWIMMING POOL
- ❾ POOL TERRACE
- ❿ OUTDOOR SHOWER
- ⓫ PRIVATE ENTRANCE

#### AREA

Total Built Up Area	236.5 sq. m. (2,546 sq. ft.)
Living Pavilion	36.3 sq. m. (391 sq. ft.)
Master Bedroom	78.4 sq. m. (844 sq. ft.)
En Suite Bathrooms	43.4 sq. m. (467 sq. ft.)
Twin Bedroom	78.4 sq. m. (844 sq. ft.)
Powder Room	3.5 sq. m. (38 sq. ft.)
Covered Walkway	7.8 sq. m. (56 sq. ft.)
Utility & Storage	14.5 sq. m. (156 sq. ft.)
Swimming Pool	25.8 sq. m. (506 sq. ft.)
Pool Terrace	26.9 sq. m. (1,426 sq. ft.)

All information and imagery correct at time of printing but may be subject to change without notice and should not be relied upon as a basis for purchase. For the latest updated information please contact us via our website [thegaleriresort.com](http://thegaleriresort.com)



#### KEY FEATURES

##### Living Pavilion

- Open plan living
- Stone flooring throughout with accent rug at living area
- Fully appointed pantry with built-in cupboards
- Accent tile backsplash
- WiFi throughout
- Integrated home entertainment system

##### Master and Twin Bedroom & En Suite Bathroom

- En suite master bathrooms
- Premium blackout curtains and blinds
- King and twin sized beds as per plan layout with hospitality quality mattresses
- His and her wardrobes and dressing area
- Full length mirror
- Built-in luggage racks and digital safes
- Dressing/makeup table with mirrors
- Mirrored his and hers double vanity with stone counter
- Luxurious freestanding tub with chandelier
- Love seat
- Glass enclosed walk-in rain-shower with stone mosaic
- Privacy glass enclosed toilette with hand spray

##### Outside Area

- Stone pool deck
- Covered timber trellis connecting master bedrooms with the living pavilion
- Open air rain shower
- Secure, ventilated owner's storage facility